

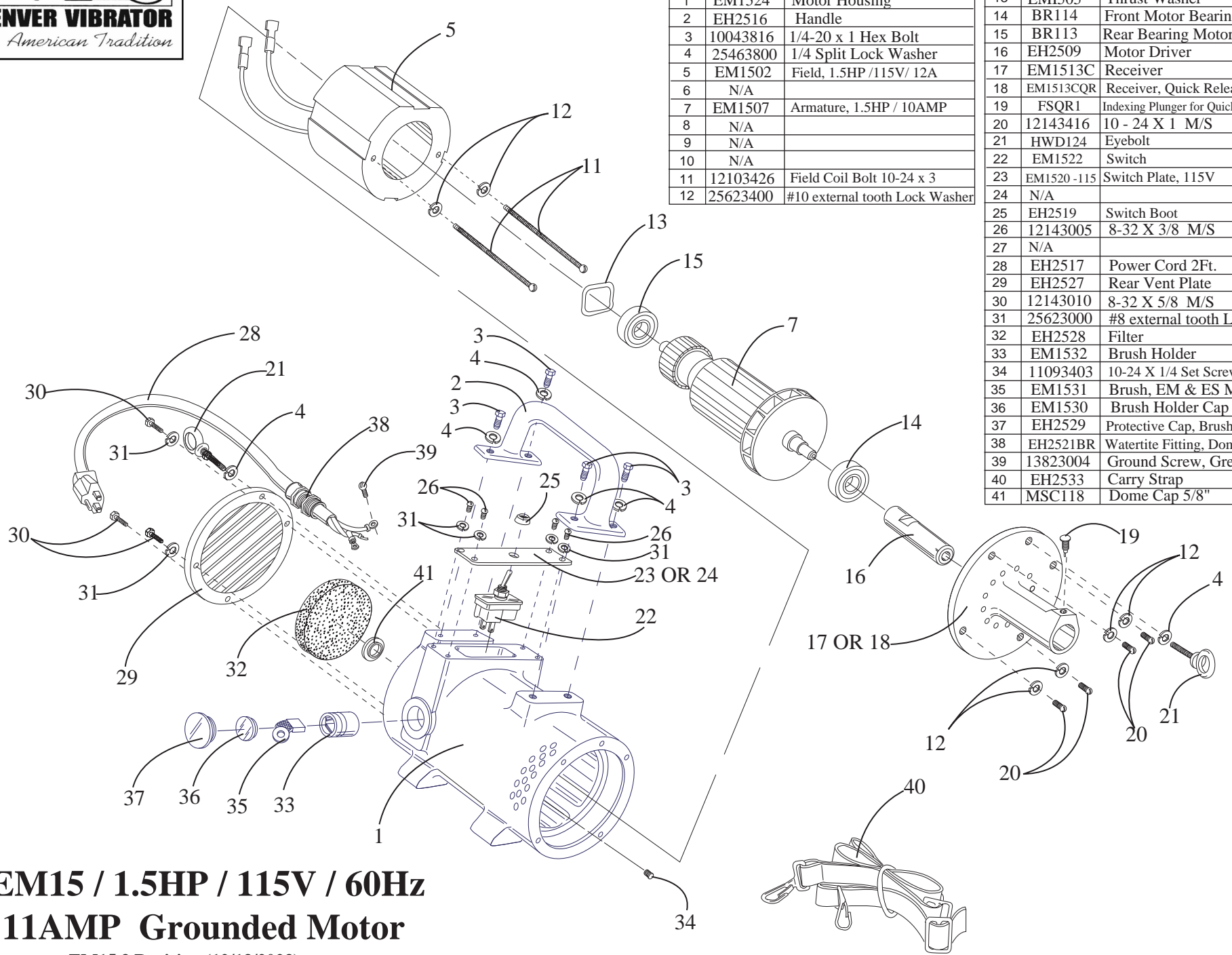

REF. No.	Part No.	Description
1	EM1524	Motor Housing
2	EH2516	Handle
3	10043816	1/4-20 x 1 Hex Bolt
4	25463800	1/4 Split Lock Washer
5	EM1502	Field, 1.5HP /115V/ 12A
6	N/A	
7	EM1507	Armature, 1.5HP / 10AMP
8	N/A	
9	N/A	
10	N/A	
11	12103426	Field Coil Bolt 10-24 x 3
12	25623400	#10 external tooth Lock Washer

REF. No.	Part No.	Description
13	EM1505	Thrust Washer
14	BR114	Front Motor Bearing
15	BR113	Rear Bearing Motor
16	EH2509	Motor Driver
17	EM1513C	Receiver
18	EM1513CQR	Receiver, Quick Release
19	FSQR1	Indexing Plunger for Quick Release
20	12143416	10 - 24 X 1 M/S
21	HWD124	Eyebolt
22	EM1522	Switch
23	EM1520-115	Switch Plate, 115V
24	N/A	
25	EH2519	Switch Boot
26	12143005	8-32 X 3/8 M/S
27	N/A	
28	EH2517	Power Cord 2Ft.
29	EH2527	Rear Vent Plate
30	12143010	8-32 X 5/8 M/S
31	25623000	#8 external tooth LW
32	EH2528	Filter
33	EM1532	Brush Holder
34	11093403	10-24 X 1/4 Set Screw Cup
35	EM1531	Brush, EM & ES Motor
36	EM1530	Brush Holder Cap
37	EH2529	Protective Cap, Brush Holder
38	EH2521BR	Watertite Fitting, Dome Style
39	13823004	Ground Screw, Green
40	EH2533	Carry Strap
41	MSC118	Dome Cap 5/8"



**EM15 / 1.5HP / 115V / 60Hz**  
**11AMP Grounded Motor**

EM15.3 Revision (12/13/2023)